

Instruction for tuning the AutoPurge System™ (APS2 and APS4)

1. Close each APS ball valve, and make sure each flow control (Fig. 1 (A)) is turned all the way clockwise.
2. Bring the Fire Protection System up to Supervisory Pressure.
3. Mark each ¼” APS purge line from all zones so that they can easily be matched to the appropriate zone number on the Quick Check Power Saver Manifold, then remove all of the ¼” purge lines from the Quick Check Power Saver Manifold.
4. Slowly, open the ball valve on each APS and then turn the APS flow control (Fig.1 (A)) counter-clockwise until the center of the float bead reaches the alphabetical setting per the label on the side of the APS (see label examples below), or to setting “D” in the event that the purge lines will be connected to a Quick Check Power Saver Manifold.
5. Once the float bead has stabilized, the ¼” tubing may be re-connected to the appropriate zone port on the Quick Check Power Saver Manifold.

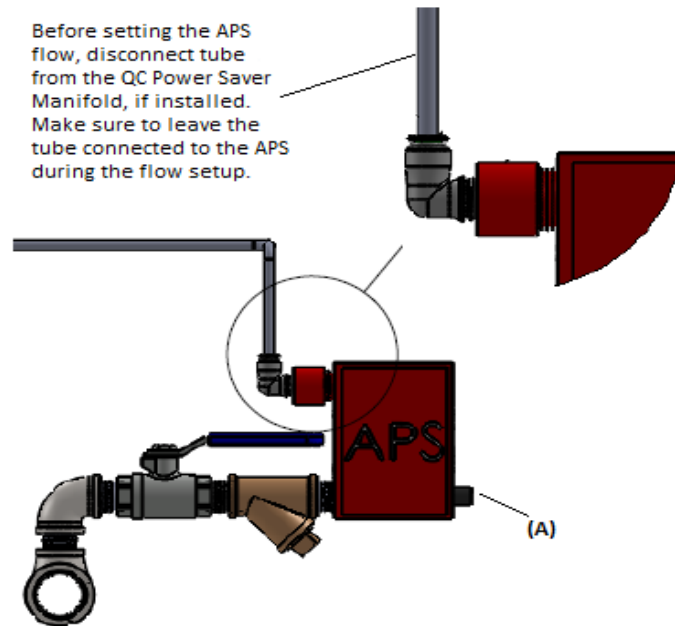

Figure 1: APS Field Installation

Gallons in Zone		APS 2 Flow Setting	
50	1/4	600	C
100	1/2	650	C+1/4
150	3/4	750	C+1/2
200	A	800	C+3/4
250	A+1/2	850	D
300	A+3/4	900	D+1/4
350	B	950	D+1/2
400	B+1/4	1000	D+3/4
500	B+1/2	1050	E
550	B+3/4		

Set the APS Flow Setting once the FPS system is at supervisory pressure. Use the bleed screw below to relieve the water check feature if no flow occurs, see manual for instructions.

Warning: AutoPurge Systems should be valved off during all FPS pressure tests. This system allows a controlled purge of the FPS system and should be set to the proper APS Flow Setting only. Other settings may cause the FPS to alarm or malfunction.

www.southteksystems.com

Figure 4: APS 2 Settings

Gallons in Zone		APS 4 Flow Setting	
1100-1200	A	2600-2750	B+3/4
1250-1500	A+1/4	2800-3050	C
1550-1700	A+1/2	3100-3300	C+1/4
1750-1900	A+3/4	3350-3600	C+1/2
1950-2050	B	3650-3850	C+3/4
2100-2300	B+1/4	3900-4000	D
2350-2550	B+1/2		

Set the APS Flow Setting once the FPS system is at supervisory pressure. Use the bleed screw below to relieve the water check feature if no flow occurs, see manual for instructions.

Warning: AutoPurge Systems should be valved off during all FPS pressure tests. This system allows a controlled purge of the FPS system and should be set to the proper APS Flow Setting only. Other settings may cause the FPS to alarm or malfunction.

www.southteksystems.com

Figure 2: APS 4 Settings



Figure 3: Alphabetical Indicators